

# Taking a Deeper Look

## Warm-up Exercise

Review this architectural plan for the Salisbury train station depot. This station was designed in 1906, after the *Plessy v. Ferguson* case, where the Supreme Court ruled that “separate but equal” accommodations for blacks and whites were legal. The decision supported state and local “Jim Crow” laws.

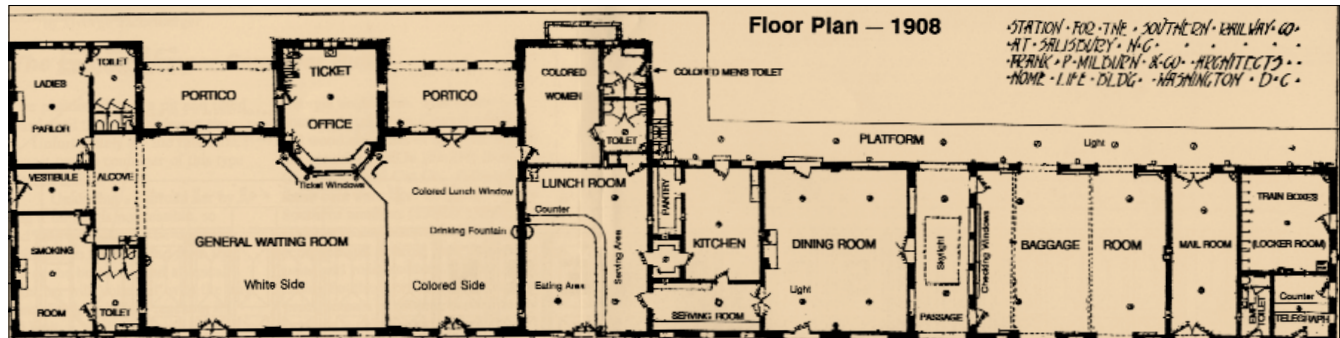

Courtesy of Historic Salisbury Foundation, Inc.

## Questions:

1. Are there any rooms that support “Jim Crow” laws? If so, provide examples.
2. Is the “ladies parlor” equal to the space marked “colored women”?
3. Have you ever experienced bias or discrimination?

## If You Were There: Creative Writing Assignment

In the 1920s, more than 12,000 African Americans worked for the Pullman Company as porters. Pullman porters connected their segregated home communities to other towns and cities across the nation by returning with news, job ads, and insight into life beyond their homes. On the job, porters worked long hours for low pay and were dependent on tips to make ends meet. George Pullman, the company owner, insisted that all porters answer to the name “George.”

Write a first-person story about a Pullman porter based on one of these situations.

- As a porter, you work long hours and have to buy your own equipment, even polish for passengers’ shoes. It is 1925 and you have been asked to support the union demands as stated by A. Philip Randolph, who is leading the Brotherhood of Sleeping Car Porters. This union will demand improved working conditions and pay. You could easily be fired by the Pullman Company or you could be a part of an organizing effort that could permanently change the status of African Americans at work. What do you do? After some research, explain why.
- You arrive in New York City after a long train ride and no sleep. You have only a few hours before returning to work. A fellow porter is taking a trip uptown to see the excitement of the Harlem Renaissance, but you are very tired and would like to sleep. Do you go to Harlem, a cultural haven created by African Americans from the South, and listen to the latest in American jazz (music you know little about), or do you rest up for your next long train ride? After some research, decide what to do. If you choose to go to Harlem, describe what you experience.